

DASHBOARD GARNISH REMOVAL/INSTALLATION

B3E091768530W02

Driver's Side

1. Disconnect the negative battery cable.
2. Remove the following parts:
 - (1) A-pillar trim (See [A-PILLAR TRIM REMOVAL/INSTALLATION.](#))
 - (2) Front scuff plate (See [FRONT SCUFF PLATE REMOVAL/INSTALLATION.](#))
 - (3) Front side trim (See [FRONT SIDE TRIM REMOVAL/INSTALLATION.](#))
 - (4) Lower panel (See [LOWER PANEL REMOVAL/INSTALLATION.](#))
 - (5) Decoration panel (See [DECORATION PANEL REMOVAL/INSTALLATION.](#))
 - (6) Dashboard center panel (See [DASHBOARD CENTER PANEL REMOVAL/INSTALLATION.](#))
 - (7) Meter hood (See [METER HOOD REMOVAL/INSTALLATION.](#))
 - (8) Instrument cluster (See [INSTRUMENT CLUSTER REMOVAL/INSTALLATION.](#))
3. Remove the screws.

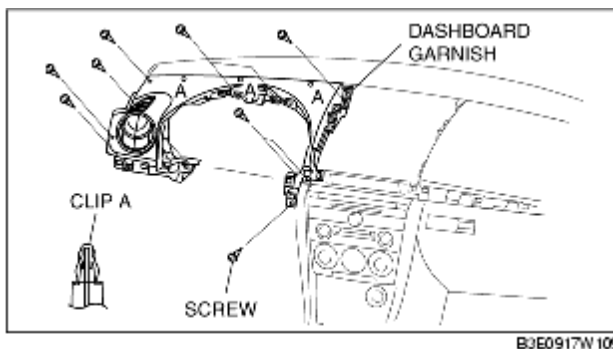

4. Pull the dashboard garnish outward, and detach clips A.
5. Remove the dashboard garnish.
6. Install in the reverse order of removal.

Passenger's Side

Warning

• Handling the air bag module improperly can accidentally deploy the air bag module, which may seriously injure you. Read the service warnings and cautions before handling the air bag module. (See [SERVICE WARNINGS.](#)) (See [SERVICE CAUTIONS.](#))

1. Disconnect the negative battery cable and wait for **1 min or more**.
2. Remove the following parts:
 - (1) A-pillar trim (See [A-PILLAR TRIM REMOVAL/INSTALLATION.](#))
 - (2) Front scuff plate (See [FRONT SCUFF PLATE REMOVAL/INSTALLATION.](#))
 - (3) Front side trim (See [FRONT SIDE TRIM REMOVAL/INSTALLATION.](#))
 - (4) Decoration panel (See [DECORATION PANEL REMOVAL/INSTALLATION.](#))
 - (5) Glove compartment (See [GLOVE COMPARTMENT REMOVAL/INSTALLATION.](#))

(6) Dashboard center panel (See [DASHBOARD CENTER PANEL REMOVAL/INSTALLATION.](#))

3. Using a flathead screwdriver, pry out the connector stopper plate.

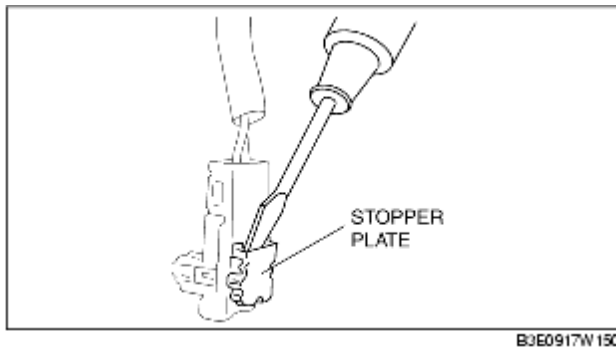

4. Disconnect the passenger-side air bag module connector.

5. Remove the bolts and screws.

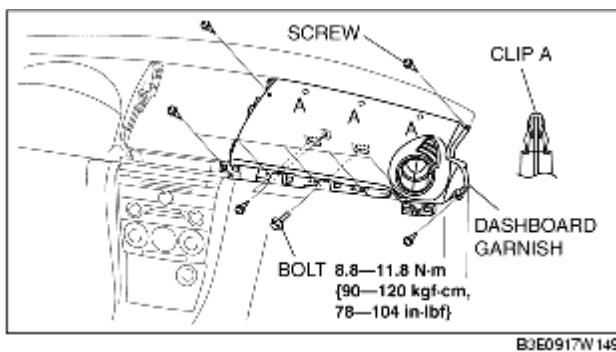

6. Pull the dashboard garnish outward, and detach clips A.

7. Remove the dashboard garnish.

8. Install in the reverse order of removal.